

PONTIAC 4W

Retractable Downlight

Classic Series

Proven. Quality. Customisable

PONTIAC 4W Retractable Downlight offers great flexibility. Its miniature size makes this a minimalist lighting, while being functional and versatile. Flexible for lighting schemes in residential or retail spaces. Direct illumination with a 30° optic reflector.

Power supply is small enough to fit through hole cutout.

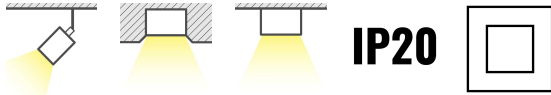

SPECIFICATIONS

Material Specifications

| | |
|---------------------------|------------------------------|
| Housing | Aluminium |
| Finish | Powder Coat |
| Dimensions | 54mm Face Dia |
| Cutout | 46mm (Dia) |
| Adjustment | 350° Rotatable, 90° Tiltable |
| Ingress Protection | IP20 |
| Warranty | 5 Year Replacement |

Electrical Specifications

| | |
|--------------------------|--|
| Power Supply | 6W LTECH power supply, Phase Dim |
| Input Voltage | 240V |
| Connection Method | Australian Approved 2-Pin Plug & 1.0m Lead |

Optic Specifications

| | |
|-----------------------------|--------------|
| Light Source | 4W SMD LED |
| Delivered Lumens | 420lm |
| Beam Angle | 30° |
| CRI | 90Ra |
| Reported L70 (Hours) | > 54,000 Hrs |

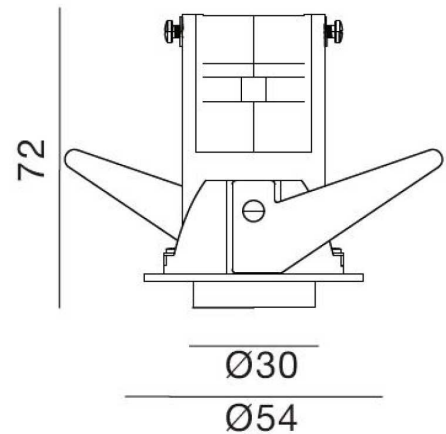

VARIATIONS

| | |
|---------------|--|
| LC4680 | PONTIAC 4W Retractable Downlight, White, Phase Dim, 3000K, 414lm |
| LC4681 | PONTIAC 4W Retractable Downlight, White, Phase Dim, 4000K, 421lm |
| LC4682 | PONTIAC 4W Retractable Downlight, Black, Phase Dim, 3000K, 419lm |
| LC4683 | PONTIAC 4W Retractable Downlight, Black, Phase Dim, 4000K, 434lm |